

Map Addendum

Soils Map

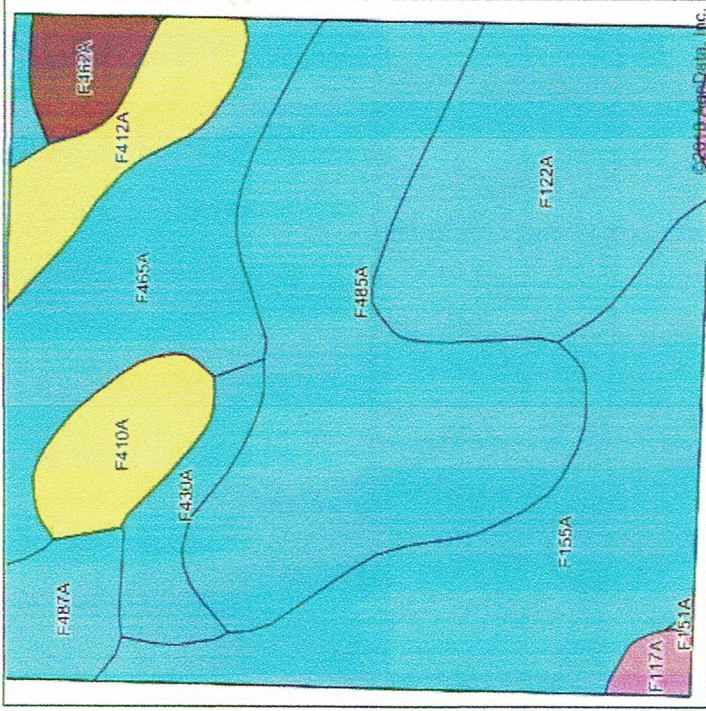

Soils data provided by USDA and NRCS.

Area Symbol: ND009, Soil Area Version: 24

Code	Soil Description	Acres field	Percent of field	Non-Irr Class Legend	Non-Irr Class °C	Productivity Index
F485A	Gardena loam, 0 to 2 percent slopes	40.83	27.0%		Ile	92
F155A	Hamlet-Balaton loams, 0 to 2 percent slopes	31.92	21.1%		Ilic	84
F122A	Svea-Cresbard loams, 0 to 3 percent slopes	26.49	17.5%		Ilic	79
F465A	Aberdeen-Overly silt loams, 0 to 2 percent slopes	20.42	13.5%		Ils	77
F412A	Hegne silty clay, 0 to 1 percent slopes	7.83	5.2%		IVw	40
F410A	Fargo silty clay, 0 to 1 percent slopes	6.74	4.5%		IVW	40
F430A	Bearden silty clay loam, 0 to 2 percent slopes	5.61	3.7%		Ile	84
F487A	Overly-Great Bend silty clay loams, 0 to 2 percent slopes	5.25	3.5%		Ilic	89
F462A	Exline silt loam, 0 to 2 percent slopes	3.92	2.6%		Vis	25
F117A	Hamerly loam, saline, 0 to 3 percent slopes	1.87	1.2%		Ils	56
F151A	Hamlet-Tonka-Hamerly complex, 0 to 2 percent slopes	0.10	0.1%		Ilic	75
Weighted Average						78.4

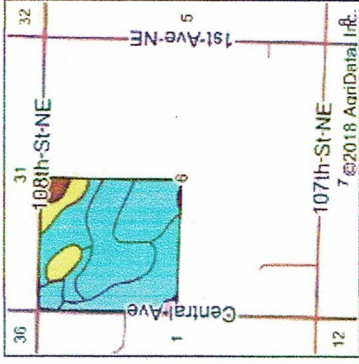

State: North Dakota
 County: Bottineau
 Location: 6-163N-77W
 Township: Haram
 Acres: 150.98
 Date: 2/20/2018

